

尺寸:100x100mm  
材质:128g铜板纸

User Manual



Remote Control  
Learning Keys

PREV/NEXT: Media key, select previous/next item.

VOL+/-: Volume up/down.

BROWSER: Open browser.

MUTE: Turn off the sound.

HOME: Fast key to go back to main menu.

RETURN: Press to go to the previous page.

MENU: Press to choose the menu of corresponding application in video, music, photo and website.

CURSOR: Press to use the navigation button as cursor.

Press OK to confirm your choice.

NAVIGATION: Press to navigate left/right/up/down.

1 s

2 sec

3 min

4 min

5 min

6 min

7 min

8 min

9 min

0

10

Number keypad 0-9

SEARCH: The corresponding search function in the APK you are using

BACKSPACE: Press to backspace the input.

**Connection**  
**AV Connection**  
a. Connect the AV cable (red/white/yellow) to the TV BOX's AV output interface, the other end to the TV set.  
b. Turn on the TV BOX, set TV video mode to AV input.

**HDMI Connection**  
a. Connect HDMI cable into the product interface, the other side into a TV set.  
b. Turn on the TV BOX, set TV video mode to corresponding HDMI input.

Connection Diagram:

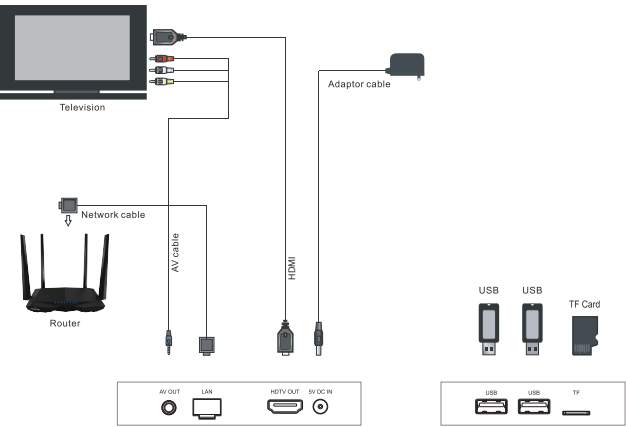

Startup:  
After the power supply is turned on, the blue light will light up, wait 30 seconds, then enter the main interface.

Screen settings:  
Open "Settings" - "Display" - "Screen position", allows you to adjust the screen zoom and position.

Resolution settings:  
Open "Settings" - "Display" - "Screen resolution", the machine defaults to automatic, you can manually adjust to your preferred resolution.

WIFI settings:  
Open "Settings" - "Network", click on the WIFI source you want to connect to. After the connection is successful, you can access the Internet.

Ethernet settings:  
Connect the Ethernet cable to the product. The machine will automatically connect.

Language settings:  
Open "Settings" - "Language", there are 24 languages, select required language.

Date & time settings:  
Open "settings" - "date & time", set your GMT time, and time display format.  
Note: The product needs to be connected to the internet to display the time correctly. If the time is displayed incorrectly, please check internet connection.

Uninstall APPS:  
Open "settings" - "APPS", select the APK you want to uninstall, press OK, click Uninstall.

Backup & reset:  
Open "Settings" - "Storage & Reset" - "Factory data reset".  
Warning: After Factory data reset - all the data will be cleared.

Update:  
Run the "UPDATE" app.  
Select OTA Update. Device will update to the latest version of firmware if it's available in the OTA server. Insert TF card or USB flash drive with update firmware to device (Make sure the updated files are on the TF card/USB flash drive's root directory). Select Local Update, click Wipe Date and Wipe Media, then confirm. The system will automatically update the program and restart after update is finished.  
(Note: During updating process, DO NOT switch off the device. In addition, this is an open platform, research and development may differ in different manufactures, DO NOT update other devices using this updating method. This is to avoid system damage.)

Troubleshooting  
Warning

Under no circumstances should you try to repair the TV BOX by yourself, as this will invalidate the warranty. Do not open it as there is a risk of electric shock. If any fault occurs, please first check the list below, before taking the device to get repaired. If you are unable to remedy a problem with the following list, contact your dealer for help.

Problem	Solution
No power	-Check if the power adaptor is properly connected to the power and the TV BOX. -Press the power button on the remote control to turn on the power.
No picture	-Re-connect with HDMI cable or AV cable, -Check if the TV is switched on.
No sound or distorted sound	-Adjust the volume. -Check that the speakers are connected correctly.
No audio or digital output	-Check the digital connections, -Check if your amplifier is set correctly.
The player does not respond to the Remote Control	-Aim the remote control directly at the sensor on the front of the TV BOX. -Reduce the distance to the TV BOX. -Replace the batteries in the remote control.
Player does not respond to some operating commands during playback	-Operations may not be permitted. Refer to the "user manual" apk pre-installed on the TV BOX -Possibility of system halted, re-insert with power adaptor to restart.
No sound during movies playback	-The audio codec may not be supported by the TV BOX. You can change to the supported audio on playing menu. -Check the volume.
The contents of the USB flash drive cannot be read	-The USB flash drive format is not compatible with the box. -If none of the USB's can be read, please turn off the TV BOX for 30 seconds and restart the TV BOX.
Slow operation of the USB flash drive	-Large size drives take longer to read and display on the TV screen.
No sound with HDMI connection	-Check the connection between the TV and the HDMI jack of the TV BOX. -Check your TV system setup. -Check the volume.
The TV screen is blank and the player LED is blinking	-Turn off your TV BOX, wait 30 seconds, turn it on again -If under HDMI status, check if HDMI connection is correct or use an alternative HDMI cable, set the output resolution of this TV BOX to 720p.

If you have any more questions, please run the "user manual" apk pre-installed on the TV BOX and refer to the user instructions and videos included.

公司名称	毕博科技	公司地址	深圳市宝安28区陆氏大厦东座五楼		
单 号		图 名	说明书	批 准	
机 型	OTT通用机型	跟 进			
料 号	BCSMSM8SPRAG	审 核		日 期	2017-6-13