



## User Manual

UL-TWS30

True Wireless Stereo Earbuds Plus

### Technical solutions:



1. Open the charging-case cover.  
The earbuds' blue LED lights will flash 3 times, followed by a clicking sound and will automatically enter the pairing state.



2. Turn on the Bluetooth of cellphone and tap "UL-TWS30" to pair.

### Memory Connection:



1. To automatically disconnect, place the earbuds into the charging-case and close the cover to enter the charging mode. Bluetooth will automatically disconnect.
2. To automatically reconnect, open the charging-case cover and connect. The earbuds will automatically connect when used again on the same device.

The earbuds will automatically switch-off after 5 minutes, if they are not utilized after opening the case.

-1-

### Utilizing the Charging Case:

Prior to using the charging-case for the first time, place the earbuds in the charging-case and connect the TYPE-C cable to charge the charging-case and the earbuds.

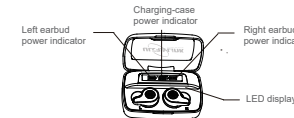

### Monitoring the Charging Display:

Charging-case power indicator:

Monitor the battery level via the charging-case power indicator. The charging-case power indicator displays 1%-100% increasing. When the device is fully charged it displays 100%.

Earbuds power indicator:

Monitor the battery level of the left earbud via the left earbud power indicator and the right earbud via the right earbud power indicator. The bars presented constitute of 20% per battery level, accumulating to 100% when all five bars are displayed; i.e. when the battery level on the earbud power indicator(L/R) displays 3 bars, the battery level is on 60%.

### Smart charging:

Charging the earbuds:

When the earbud is placed in the charging-case, it will automatically enter the charging mode. When the earbuds(L/R) are in the charging state, the red LED light will always be on. The charging case display will correspond to the earbuds being charged(L/R). When the earbud/s are fully charged, the red LED light will switch-off and the blue LED light will switch- on. If the corresponding earbud is fully charged according to the display screen, it will enter sleep mode after 15 seconds.

-2-

Charging the Charging-case:

Insert the charging cable into the TYPE-C interface, the charging-case will automatically charge. When charging, the display screen will change accordingly. When the charging case power indicator displays 100% the charging-case is fully charged. Gently place the earbud into its charging socket in order to avoid contact with the charging probe.

### Multi-function Button Control:



#### Single Press

- Answer/hang up (call)
- Play/pause (music)
- Exit standby mode



#### Press-and-Hold

- Power on
- Reject second call
- Switch calls
- Left/volume reduction
- Right/volume plus
- Power off: press & hold for 6 seconds



#### Double Press

- Reject (call)
- Left/previous piece (music)
- Right/next track (music)



#### Three strikes

- Activate SIRI (Only applicable on IOS)

-3-

### Charging the earbuds:

During the charging process, the earbuds LED light will always be red, and the LED light will switch-off when the earbuds are fully charged.

### Low power alert:

Low power can only be maintained for 5 minutes, thereafter a tone will play every 20 seconds, this indicates that the earbuds need to be charged.

### Indicator lamp:

Charging	Red LED light stays on
Charging Finished	Blue LED light stays on
Pairing	Red & Blue LED light flashes
Pairing Successful	LED light switches-off

While charging, the charging-case power indicator will switch-on

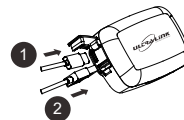

1. Charging the charging-case: Insert the charging cable into the TYPE-C interface. When the charging status is displayed, the charging-case power indicator displays 1%-100% increasing, and when the charging-case is fully charged, it displays 100% power.
2. Utilizing the charging-case as a power bank: When the charging-case is fully charged, insert the cellphone cable into the USB-A output port and charge it. When the cellphone is charging, the power of the charging-case power indicator displays 100%-1% decreasing, until the cellphone is fully charged or the charging-case is out of power.

-4-

### Correct way of wearing:



### Incorrect way of wearing:



### Detail Information:

- Size of Earphone: 27mm (L) x 23mm (W) x 23mm (H)
- Weight of Earphone: 5.5g
- Typical Capacity: 85mAh
- Charging Time: 2.5 Hours
- Working Voltage: 3.3V - 4.2V
- Standby Time: 5 minutes
- Music Play-time & Talking Time: 10-12 Hours
- Bluetooth Version: V5.0
- Support for Profile: Tensilica HiFi EP, Hardware FFT, SRC, Filter, MCSync TWS+
- RF Emission Frequency: Class 2
- Transmission Category(Hz): 2.402 GHz-2.480 GHz
- Transmission Distance: 10m
- Audio Sampling Accuracy: 16 Bits
- Audio Sampling Rate: 96 kHz
- Audio Coding Format: CVSD, mSBC, SBC, AAC
- Noise-signal Ratio: > 95 dB
- Working Temperature: -15°C - 60°C
- Working Wet: 10% - 85% (Non-freezing state)

-5-

### Earbud speaker information:

Specification: Ø6 mm  
Impedance: 32 Ω  
Frequency(Hz): 20 Hz- 20 kHz  
Sensitivity: 93±3 dB  
Input Power: 2mW - 5mW

### Microphone information:

M/C Style: Silicon Microphone  
M/C Sensitivity: -42 ±3 dB  
SPL: 130 dB

### Security precautions:

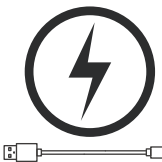

#### Note:

Avoid listening to music at a high volume for a long period of time, as it can cause hearing loss or permanent hearing damage.

In order to avoid damaging the product, remove the charger when the device's battery is fully charged.

5V/1A OR 5V/1.5A is the recommended power for charging, if the output voltage and current of the charger exceeds the specified value, the product will be damaged and the warranty will be null and void.

-6-

### True Wireless Plus Earbuds Guidelines:

- 1.DO NOT use the device in a large electromagnetic field or strong radiation environment, as the Bluetooth signal will be affected and will have connection issues.
- 2.DO NOT use the device when its battery is less than 10%, as it may automatically disconnect or have connection issues.
- 3.DO NOT use the device in the presence of multiple 2.4 GHz co-channel signals, as the device's Bluetooth signal may have connection issues.
- 4.DO NOT press the device vigorously or submerge it as it may cause damage to the device's speaker and sound quality.
- 5.DO NOT leave the device uncharged after every 30 days, as it might not switch-on due to low battery.
- 6.Refer to UL-TWS30 when updating the software, hardware or appearance as there may be new developments on the model.

### DISCLAIMER:

The True Wireless Plus Stereo Earbuds is covered with a 1 year warranty from date of purchase. The warranty granted by Interfoto CC shall be deemed null and void if the product is used for any other purpose other than its intended use or if the product is opened and serviced by any other person or company other than Interfoto CC during the warranty period. Use of this product is at the users own risk.



If you are experiencing any problems with the setup or the product itself please contact:  
INTERFOTO CC

Website: [www.interfoto.co.za](http://www.interfoto.co.za)  
Email: [service@interfoto.co.za](mailto:service@interfoto.co.za)  
Address: 362 Roan Crescent,  
Corporate Park North, Midrand  
Tel: +2786 006 1046

-8-