

**FXN<sup>®</sup> V900**



**USER MANUAL**

Thank you for choosing PXN's product and supporting brand.  
Please read the manual carefully before using.

## ● Product Features

1. Compatible with PC/PS3/PS4/XBOX ONE/SWITCH.
2. Intelligent dual-core for two modes of X-input and D-input in PC.  
Fit for different games.
3. Buttons are programmable according to your habits.
4. Switch between 270° and 900° rotation output.
5. Support audio communication function at PS4/XBOX ONE.
6. Built-in double vibration motors, bring you realistic gaming experience.
7. Racing Wheel with ergonomic structure design.

## What's in the box

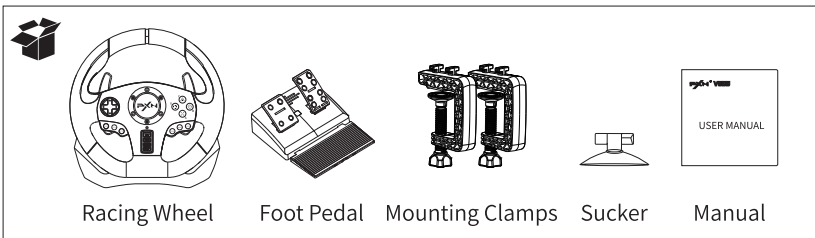

## ● Button

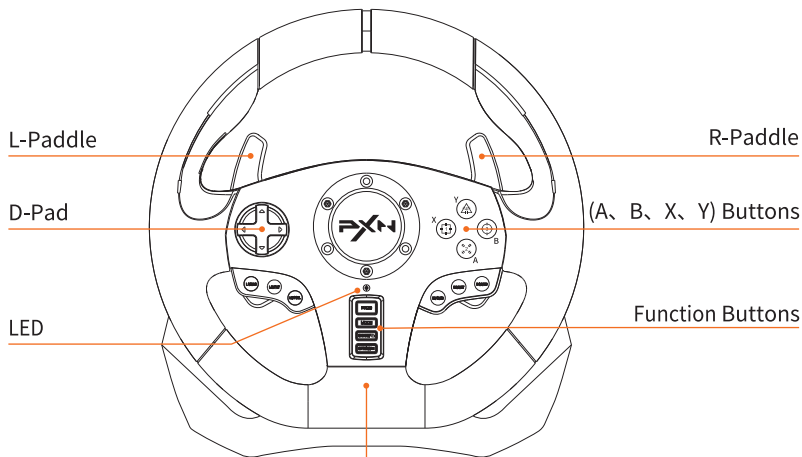

90° 270°  
Switching Angles

A small diagram of a sliding switch. The switch is shown in two positions: one with the slider at the left end labeled '90°' and one with the slider at the right end labeled '270°'. Below the diagram is the text 'Switching Angles'.

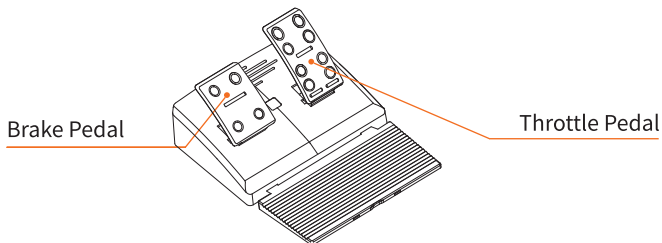

## ● System Requirements

Support Platform: PC/PS3/PS4/XBOX ONE/SWITCH

PC System: Windows 7/8/10

## ● Installation

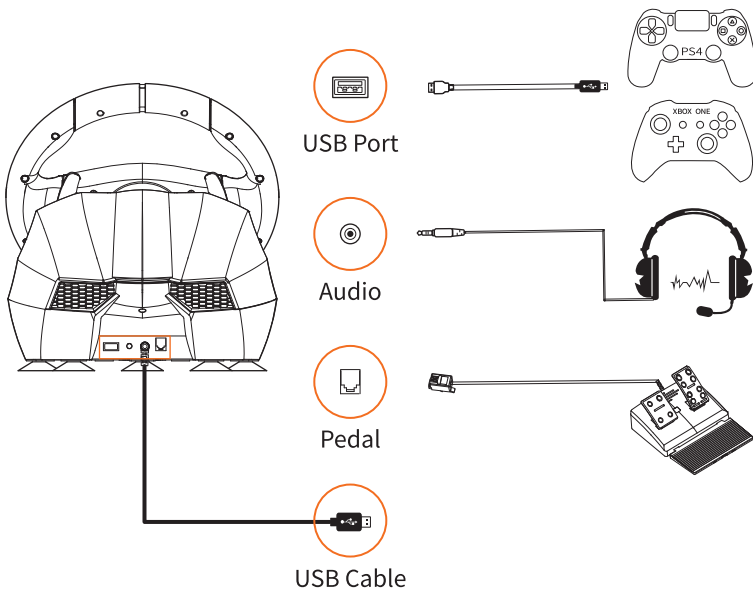

Attach Foot Pedal and USB cables as show

## ● Mounting clamps

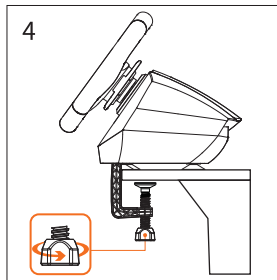
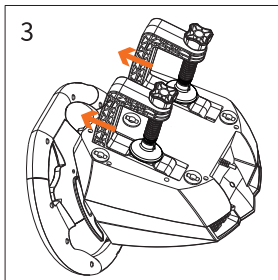
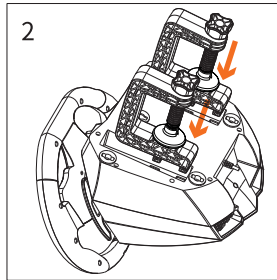
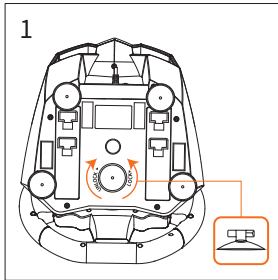

Racing Wheel is equipped with a clamping system for mounting to a table.

Step1 Match the sucker with racing wheel, and then rotate to lock.

Step2 Rotate clamp knobs to loosen clamps.

Step3 Match the clamps with Racing Wheel.

Step4 Mounting the Racing Wheel to a table and then rotate clamp knobs to tighten clamps.

## ● Using for PC

Switch MODE between X-input and D-input.

X-INPUT ← Press "MODE" 3s → D-INPUT

Racing Wheel is default to X-input mode when connecting computer, and red LED keeps lighting on.

### X-input mode

X-input MODE is compatible with Games for windows, Plug and play.

Recommended Games: "Need for Speed 13" above version, "Dirty2/3/4", "Ridge Racer" and so on.

### D-input mode

D-input MODE is compatible with early PC racing games.

Recommended Games: "Need for Speed 1-12", "Euro Truck Simulator" and so on.

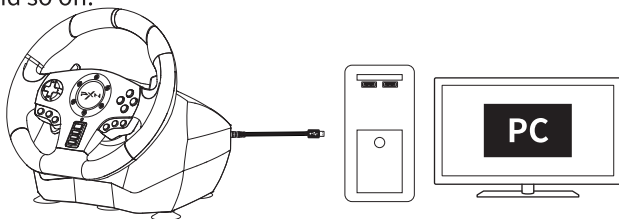

Diagram of PC Connection

## ● Using for PS3 Console

- ① Connect the Racing Wheel to the USB port of the PS3.
- ② When the Red LED light keeps on, it can start to play game or set functions on PS3.

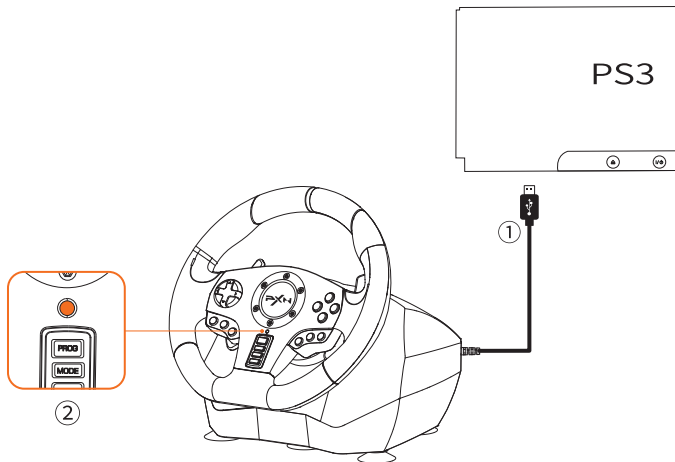

Diagram of PS3 Connection

## ● Using for PS4 Console

- ① Power off the original controller of PS4.
- ② Connect the Racing Wheel with PS4 controller by Micro USB cable
- ③ Plug the USB of Racing Wheel into PS4 USB interface.
- ④ Press the button of "MODE". After that the Racing Wheel can start to play game and setting.

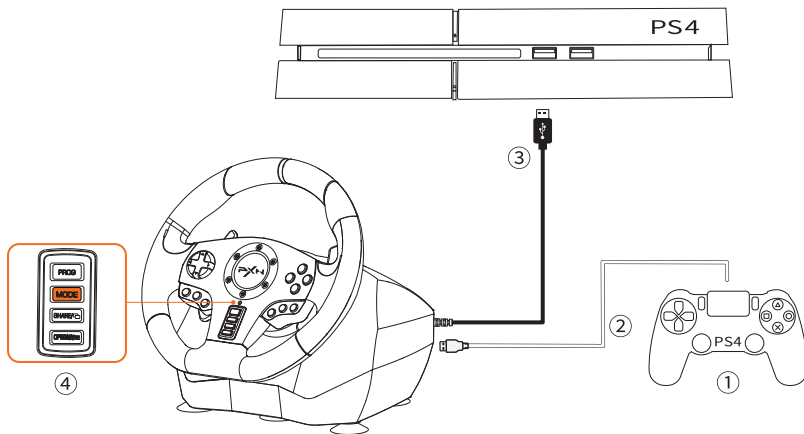

Diagram of PS4 Connection



## ● Using for XBOX ONE Console

- ① Power off the original controller of XBOX ONE.
- ② Connect the Racing Wheel with console controller by Micro USB cable.
- ③ Plug the USB of Racing Wheel into console USB interface.
- ④ Press the button of "MODE". After that the Racing Wheel can start to play game and setting.

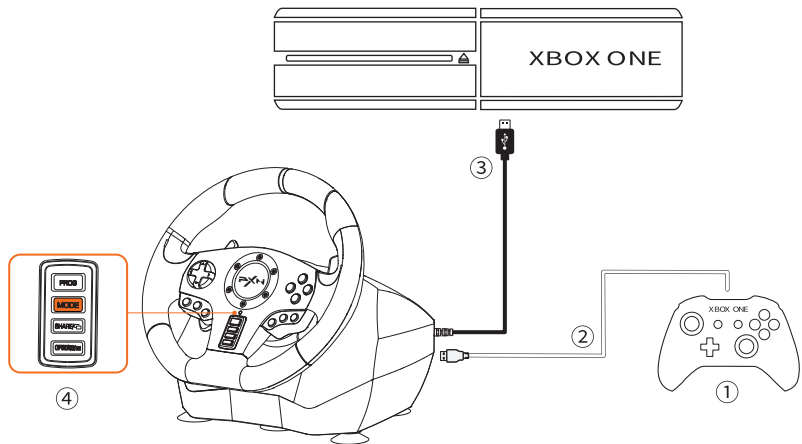

Diagram of XBOX ONE Connection

## ● Using for Nintendo Switch

- \* Enter System settings (⚙️) Controllers and Sensors, select Pro Controller Wired Communication. Select the option state to ON.

### Connect With Switch Console

- ① Connect the TYPE-C OTG with the USB of Racing Wheel.
- ② Connect the USB main cable of the Racing Wheel to Switch Console.
- ③ Power on Switch console to play.

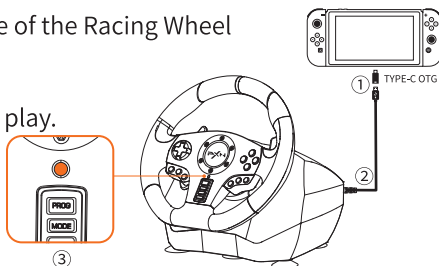

### Connect With Switch dock

- ① Place the Switch dock and ensure successful connection.
- ② Plug the USB of Racing Wheel into Switch dock and power on Switch console.

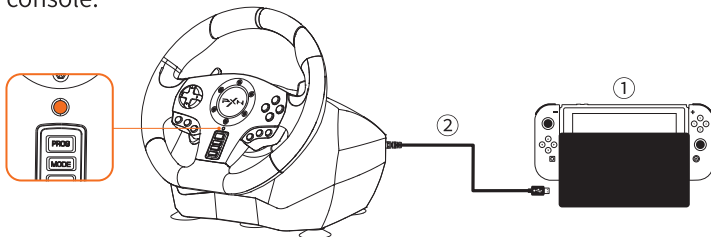

## ● Sensitivity Setting

### High sensitivity:

Press the "PROG" Button, the Red LED flashes quickly, press the D-pad "↑" button.(Recommend for PS3, PS4, XBOX ONE console)

### Medium sensitivity:

Press the "PROG" button, the Red LED flashes quickly, press the D-pad "←" button.

### Low sensitivity:

Press the "PROG" button, the Red LED flashes quickly, press the D-pad "↓" button.(Recommend for PC platform)

## ● Customize maximum effective turn radius

### Max effective turn radius

For example, the Racing Wheel maximum effective turn radius is set to 180°. The actual maximum turn radius is achieved when moving 90° to the left or right, and the rotation exceeding 90° is invalid rotation.

### How to setting?

① Switch to 900°.

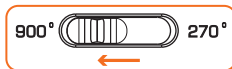

② Press the "PROG" button, the Red LED flashes quickly.

- ③ Move the Racing Wheel to the desired angle ( more than 60°), press the "OPTIONS" button, the Red LED will keep on.

## ● Programmable Buttons Function

Setting buttons: L-paddle, R-paddle, L-pedal, R-pedal, L3, R3

Buttons can be programmed: A、B、X、Y、L1、L2、R1、R2

### How to setting?

- ① Press "PROG", Red LED light flashes quickly.
- ② Press setting button, Red led light flashes slowly.
- ③ Press programmable buttons, The Red LED is on and the setting is complete.

### How to clear button programmed function?

Clear single button

- ① Press "PROG", Red LED light flashes quickly.
- ② Press setting button twice, the Red LED is on and the clear is complete.

Clear all buttons

- ① Press "PROG", Red LED light flashes quickly.
- ② Press the "OPTIONS" button for 4 seconds, the Red LED will be on, all the programmed buttons will be restored, and the

Racing Wheel rotation sensitivity will return to the highest sensitivity.

## Notes

1. Press "PROG" button, the Red LED flashes quickly, and then press the "PROG" button again to exit programming. The previous data does not change.
2. Press "PROG" button, the Red LED flashes quickly. If there is no action at this time, the programming will automatically exit after 10 seconds.

## ● Voice Communication Function

The Racing Wheel supports to connect with headset and microphone, allowing player to connect headset for voice communication on PS4 / XBOX ONE console.

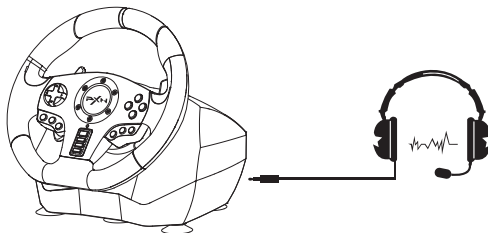

Diagram of Headphone Connection

## ● Attentions

1. Avoid fierce vibration. Don't take apart, revise and mend by yourself.
2. Don't let water or other liquid entering inside of the Racing wheel to make any damages.
3. Don't store in places of high humidity, temperature, heavy oil or smoke.
4. Don't drop the Racing wheel into fire or explosion danger may be caused by built-in battery.
5. Children should be under the custody of adults to use this product.

## ● Product Specification

Mode No.	PXN-V900
Connection	USB Wired
Working Current	80mA-500mA
Packing Size	Appr. 325*305*295mm
Product Size	Appr. 280*340*285mm
Net Weight	Appr. 3280g
Application Temperature	10-40°C
Application Humidity	20~80%